

CHANNEL IMPROVEMENT PROJECT
MATAGORDA SHIP CHANNEL, TEXAS

ENGINEERING APPENDIX FOR
MATAGORDA SHIP CHANNEL
FEASIBILITY STUDY



Coastal Navigation and Environmental Restoration

Office of the District Engineer
U. S. Army Engineer District, Galveston
Corps of Engineers
Galveston, Texas

July 2019



File: W:\cadd\projects\quad\705-238 MSC CG Deepening\Plans\0-GUAD-705-238_CONTRACT-PLANS_TxSc83.dgn
 Model Name: G-2-Location
 By: M3ECKBRH Date: 3/5/2019 Time: 3:10:35 PM

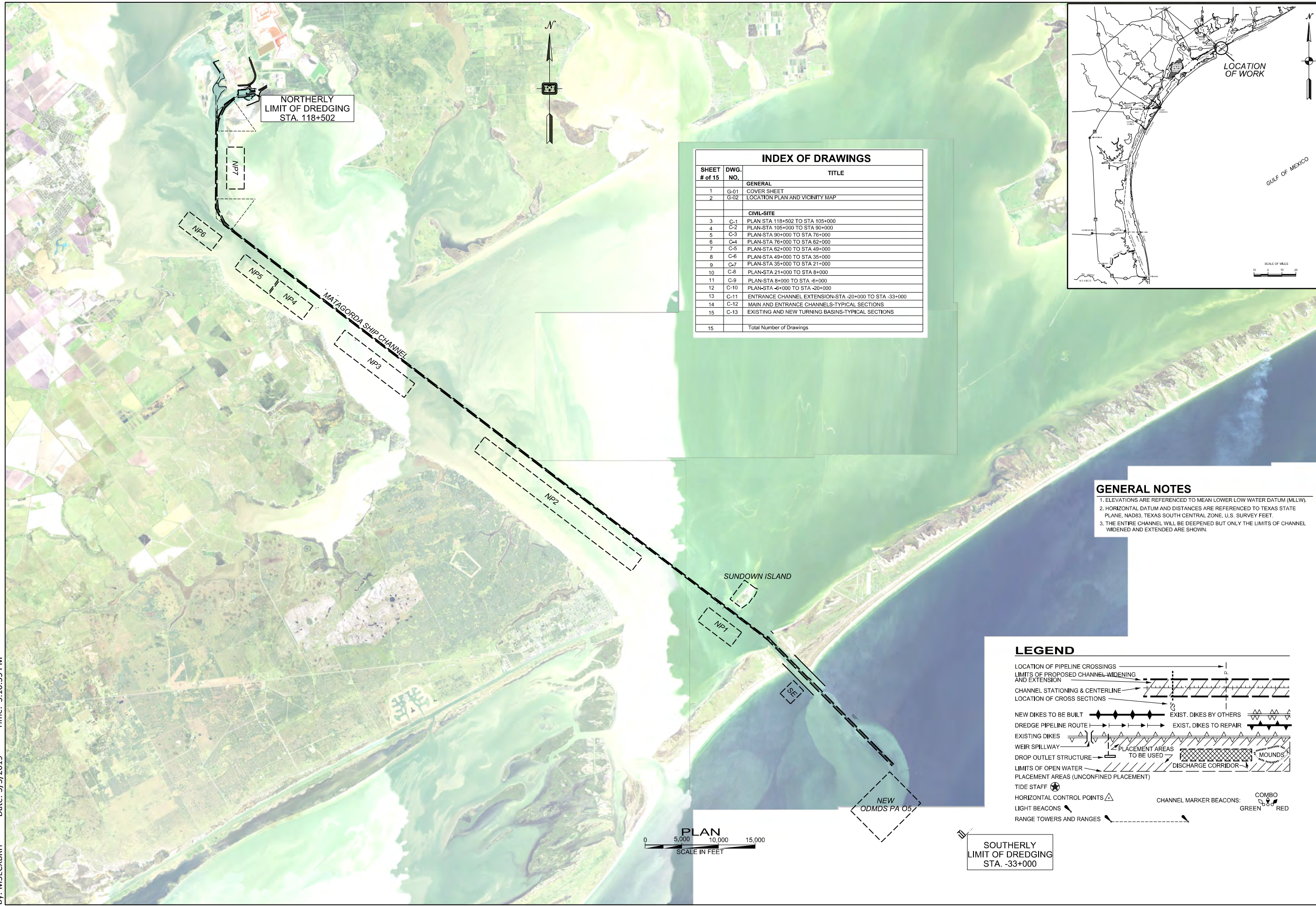

INDEX OF DRAWINGS		
SHEET # of 15	DWG. NO.	TITLE
GENERAL		
1	G-01	COVER SHEET
2	G-02	LOCATION PLAN AND VICINITY MAP
CIVIL-SITE		
3	C-1	PLAN STA 118+502 TO STA 105+000
4	C-2	PLAN STA 105+000 TO STA 90+000
5	C-3	PLAN STA 90+000 TO STA 76+000
6	C-4	PLAN STA 76+000 TO STA 62+000
7	C-5	PLAN STA 62+000 TO STA 49+000
8	C-6	PLAN STA 49+000 TO STA 35+000
9	C-7	PLAN STA 35+000 TO STA 21+000
10	C-8	PLAN STA 21+000 TO STA 8+000
11	C-9	PLAN STA 8+000 TO STA -6+000
12	C-10	PLAN STA -6+000 TO STA -20+000
13	C-11	ENTRANCE CHANNEL EXTENSION-STA -20+000 TO STA -33+000
14	C-12	MAIN AND ENTRANCE CHANNELS-TYPICAL SECTIONS
15	C-13	EXISTING AND NEW TURNING BASINS-TYPICAL SECTIONS
15		Total Number of Drawings

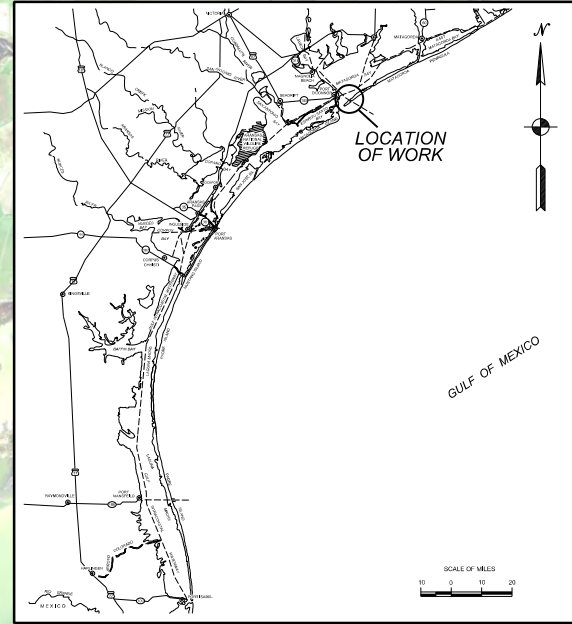

GENERAL NOTES

- ELEVATIONS ARE REFERENCED TO MEAN LOWER LOW WATER DATUM (MLLW).
- HORIZONTAL DATUM AND DISTANCES ARE REFERENCED TO TEXAS STATE PLANE, MADRID, TEXAS SOUTH CENTRAL ZONE, U.S. SURVEY FEET.
- THE ENTIRE CHANNEL WILL BE DEEPEND AND ONLY THE LIMITS OF CHANNEL WIDENED AND EXTENDED ARE SHOWN.

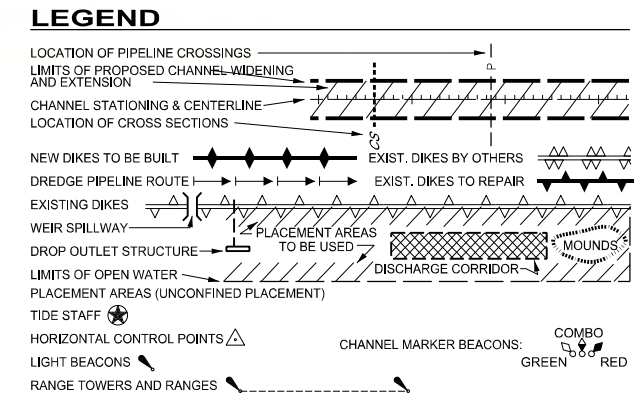

SOUTHERLY LIMIT OF DREDGING STA. -33+000

U.S. Army Corps of Engineers
Galveston District

Drawn by:	X	Date:	###	Rev.
Checked by:	X	Scale:	AS SHOWN	
Submitted by:	LORIK, THOMAS, P.E.	Approval Recommended by:	JOSEPH L. KING, R.A.	
Approved by:	ROBERT C. THOMAS, P.E.	Chief, Engineering Branch		
		Chief, Engineering and Construction Division		

U.S. ARMY ENGINEER DISTRICT, GALVESTON
CORPS OF ENGINEERS
GALVESTON, TEXAS

PREPARED UNDER THE DIRECTION OF
LARS N. ZETTERSTROM, P.E.,
COLONEL, U.S. ARMY, COMMANDING

CHANNEL IMPROVEMENT PROJECT
MATAGORDA SHIP CHANNEL, TEXAS

MATAGORDA SHIP CHANNEL
FEASIBILITY STUDY
LOCATION AND VICINITY

Drawing No.:
G-2

SWG FILE NO. ###

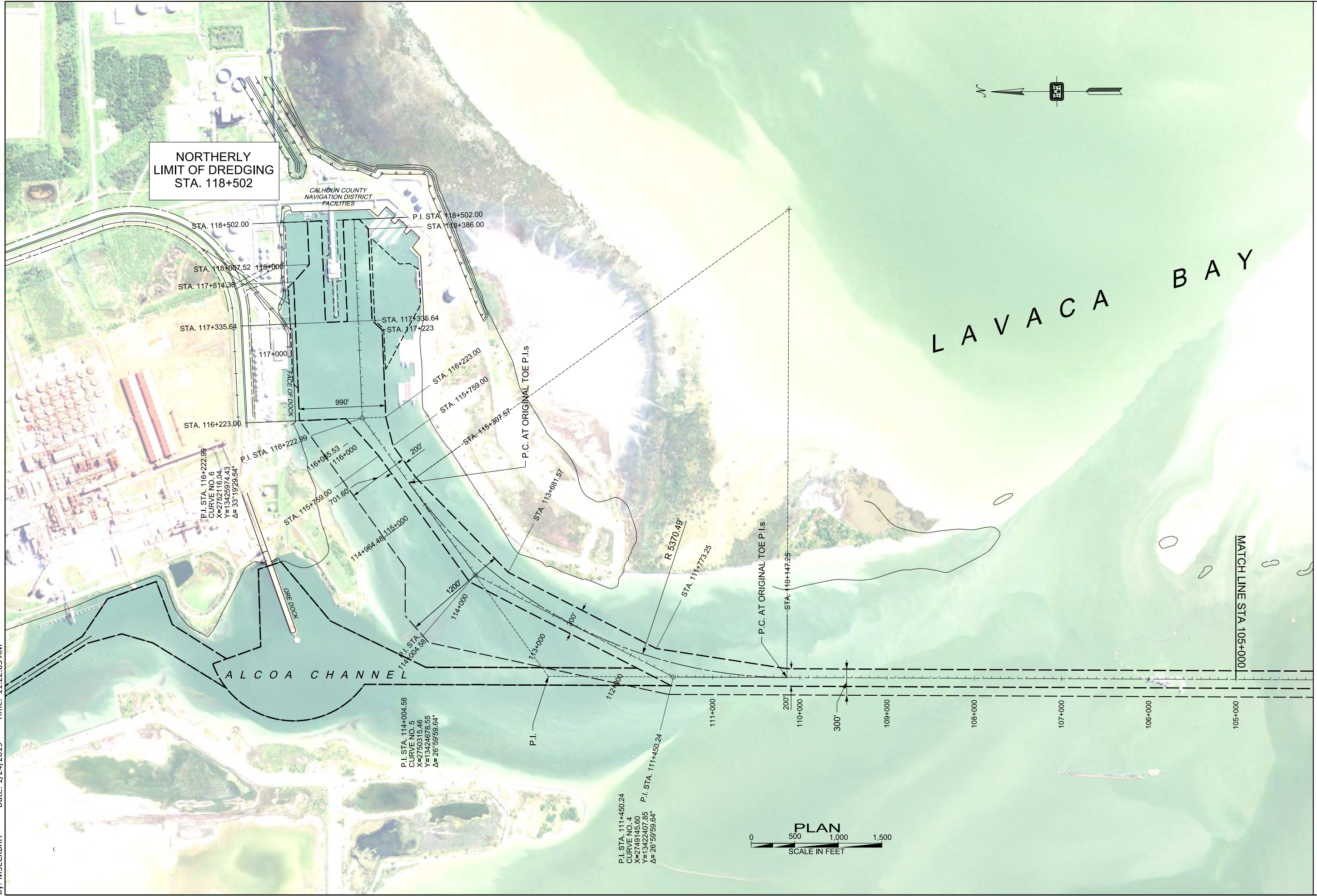

Rev.	Date	Description

Drawn by:	X	Date:	###
Designed by:	X	Scale:	AS SHOWN
Checked by:	X	Approval Recommended by:	JOSEPH L. KING, R.A., Chief, Engineering Branch
Submitted by:	LORI K. THOMAS, P.E.	Approved by:	ROBERT C. THOMAS, P.E., Chief, Engineering and Construction Division

U.S. ARMY ENGINEER DISTRICT GALVESTON
 CORPS OF ENGINEERS
 GALVESTON, TEXAS
 PREPARED UNDER THE DIRECTION OF
 LARS N. ZETTERSTROM, P.E.,
 COLONEL, U.S. ARMY, COMMANDING

CHANNEL IMPROVEMENT PROJECT
 MATAGORDA SHIP CHANNEL, TEXAS
 ###
 MATAGORDA SHIP CHANNEL
 FEASIBILITY STUDY
 PLAN-STA 118+502 TO STA 105+000

Drawing No.:
C-1
 SWG FILE NO. ###

File: 0-GUAD-705-238_CONTRACT-PLANS_TxSc83.dgn
 Model Name: C-3-Lavaca Bay Cont
 By: M3ECKBRH Date: 1/24/2019 Time: 12:40:26 PM

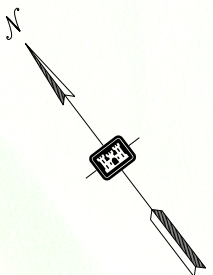
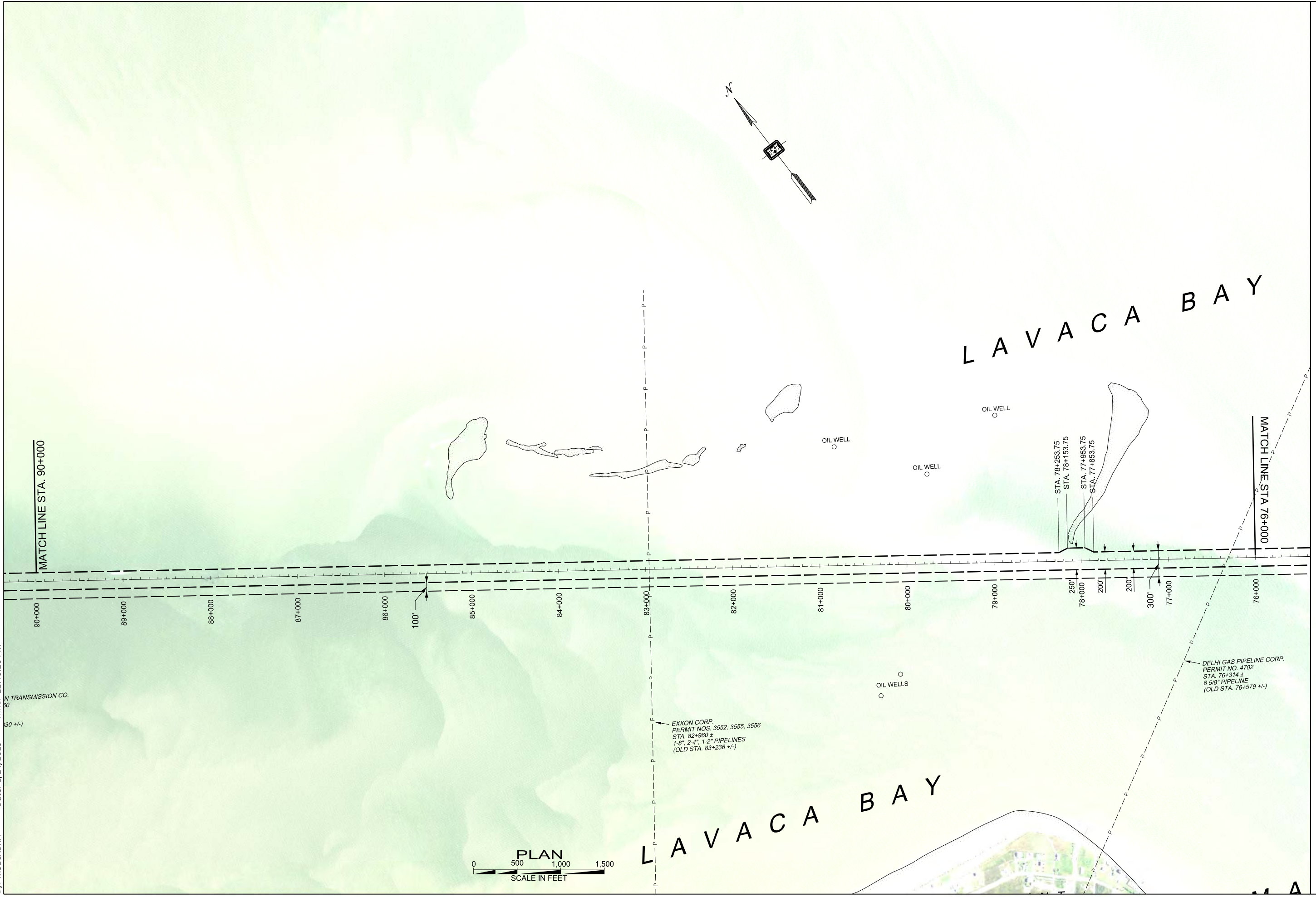

Rev.	Date	Description

Drawn by:	X	Date:	###
Designed by:	X	Scale:	AS SHOWN
Checked by:	X	Approval Recommended:	JOSEPH L. KING, R.A., Chief, General Engineering
Submitted by:	LORI K. THOMAS, P.E.	Approved:	ROBERT C. THOMAS, P.E., Chief, Engineering and Construction Division
U.S. ARMY ENGINEER DISTRICT GALVESTON CORPS OF ENGINEERS GALVESTON, TEXAS PREPARED UNDER THE DIRECTION OF LARS N. ZETTERSTROM, P.E., COLONEL, U.S. ARMY, COMMANDING			

CHANNEL IMPROVEMENT PROJECT
 MATAGORDA SHIP CHANNEL, TEXAS
 #
 MATAGORDA SHIP CHANNEL
 FEASIBILITY STUDY
 PLAN-STA 90+000 TO STA 76+000

Drawing No.:
C-3
 SWG FILE NO. ###

File: 0-GUAD-705-238_CONTRACT-PLANS_Txs683.dgn
 Model Name: C-4-Matagorda Bay-1
 By: M3ECXBRH Date: 1/24/2019 Time: 12:50:15 PM

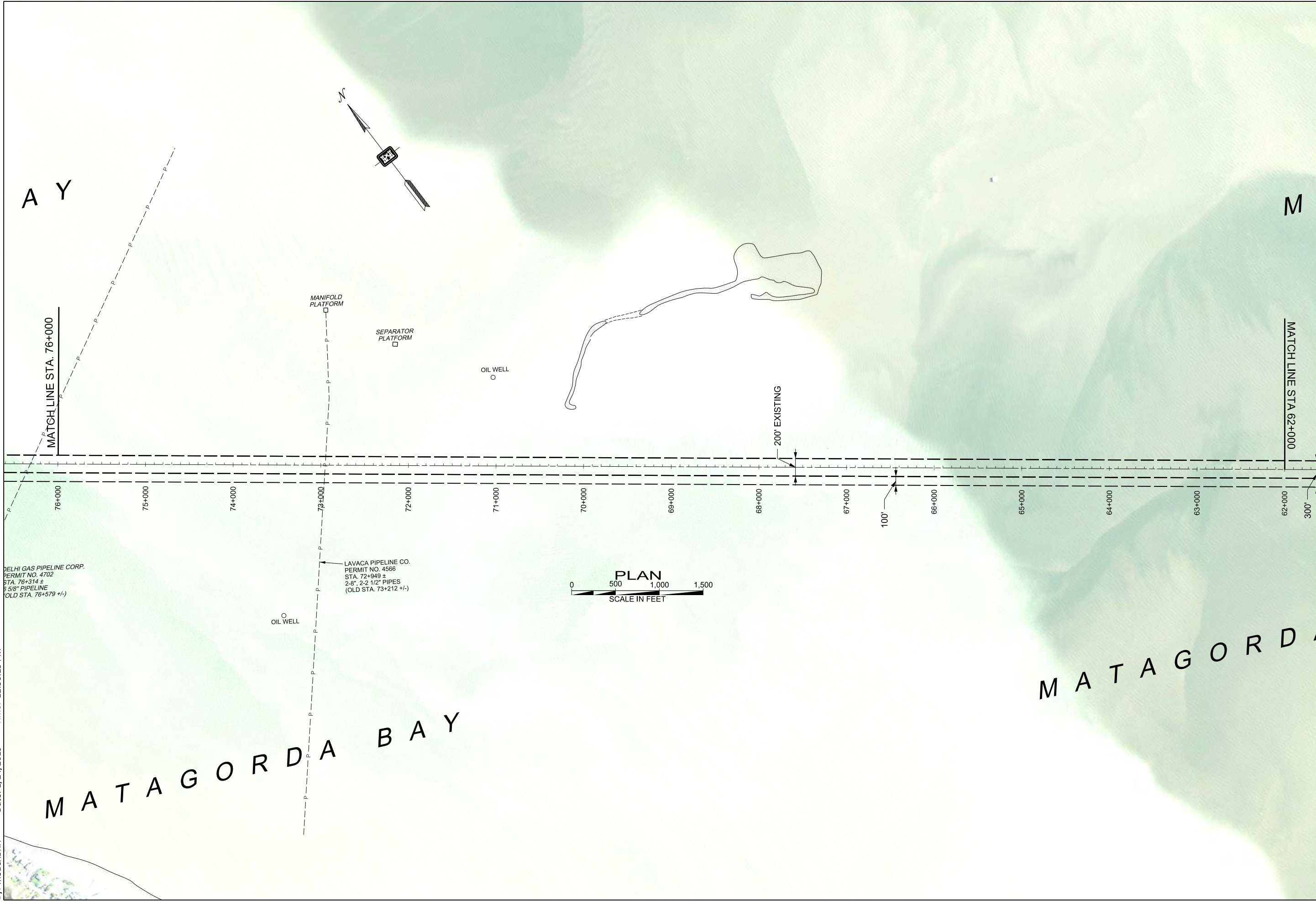

Rev.	Description	Date	By

Drawn by:	X	Date:	###
Designed by:	X	Scale:	AS SHOWN
Checked by:	X	Approval Recommended:	JOSEPH L. KING, R.A., Chief, Engineering Branch
Submitted by:	LORI K. THOMAS, P.E.	Chief, Engineering Branch	ROBERT C. THOMAS, P.E., Chief, Engineering and Construction Division
Approved by:	ROBERT C. THOMAS, P.E.	Chief, Engineering and Construction Division	

U.S. ARMY ENGINEER DISTRICT GALVESTON
 CORPS OF ENGINEERS
 GALVESTON, TEXAS

PREPARED UNDER THE DIRECTION OF
 LARS N. ZETTERSTROM, P.E.,
 COLONEL, U.S. ARMY, COMMANDING

CHANNEL IMPROVEMENT PROJECT
 MATAGORDA SHIP CHANNEL, TEXAS
 #####
 MATAGORDA SHIP CHANNEL
 FEASIBILITY STUDY
 PLAN-STA 76+000 TO STA 62+000

Drawing No.:
C-4
 SWG FILE NO. #####

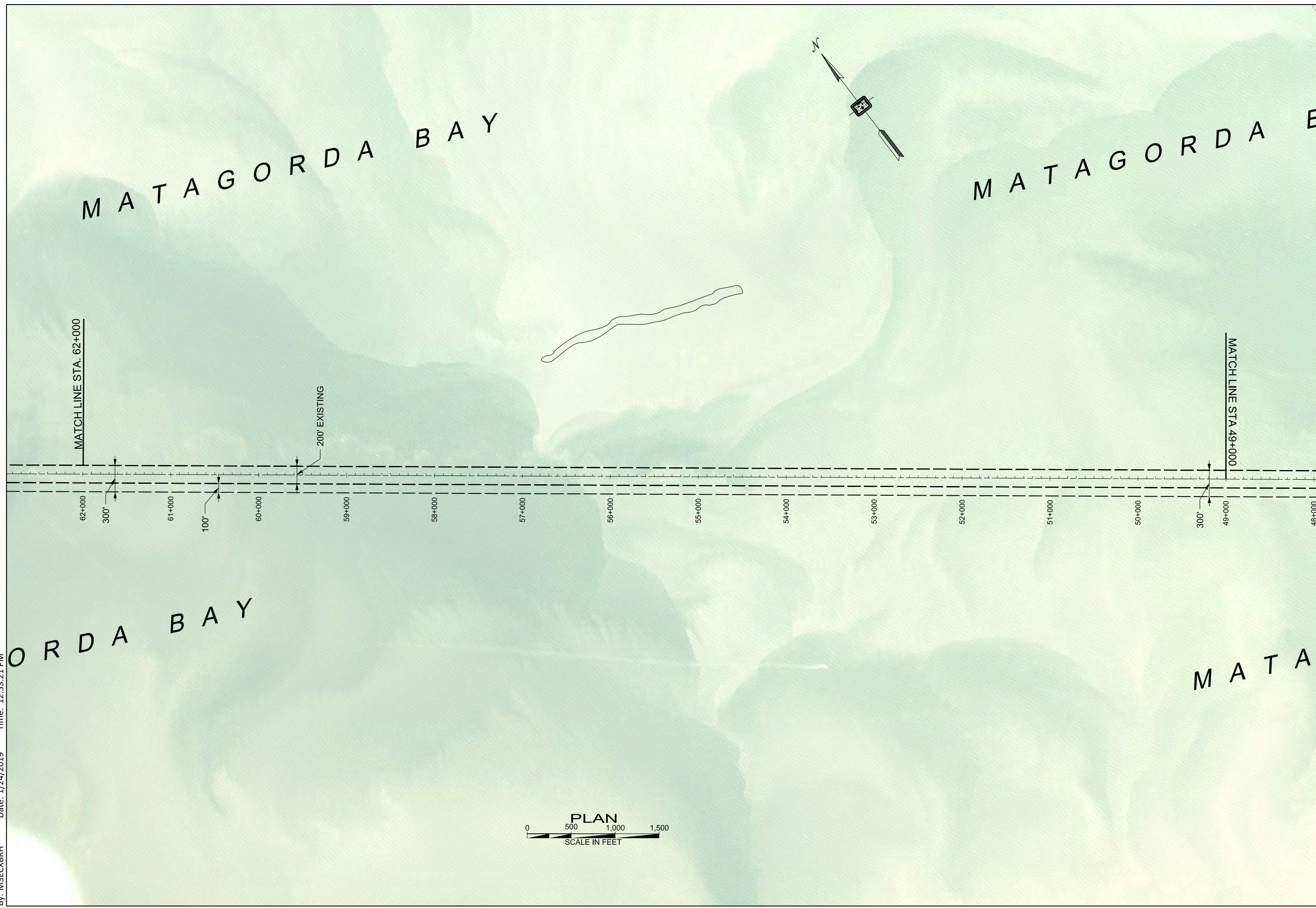

Rev.	Date	Description

Drawn by:	X	Date:	###
Designed by:	X	Scale:	AS SHOWN
Checked by:	X	Approval Recommended:	JOSEPH L. KING, R.A., Chief, General Engineering
Submitted by:	LORI K. THOMAS, P.E.	Chief, Engineering Branch	ROBERT C. THOMAS, P.E., Chief, Engineering and Construction Division
U.S. ARMY ENGINEER DISTRICT, GALVESTON CORPS OF ENGINEERS GALVESTON, TEXAS			
PREPARED UNDER THE DIRECTION OF LARS N. ZETTERSTROM, P.E., COLONEL, U.S. ARMY, COMMANDING			

CHANNEL IMPROVEMENT PROJECT
 MATAGORDA SHIP CHANNEL, TEXAS
 #####
 MATAGORDA SHIP CHANNEL
 FEASIBILITY STUDY
 PLAN-STA 62+000 TO STA 49+000

Drawing No.:
C-5
 SWG FILE NO. #####

File: 0-GUAD-705-238_CONTRACT-PLANS_Txs683.dgn
 Model Name: C-6-Matagorda Bay-3
 By: M3CXBRH Date: 1/24/2019 Time: 12:57:31 PM

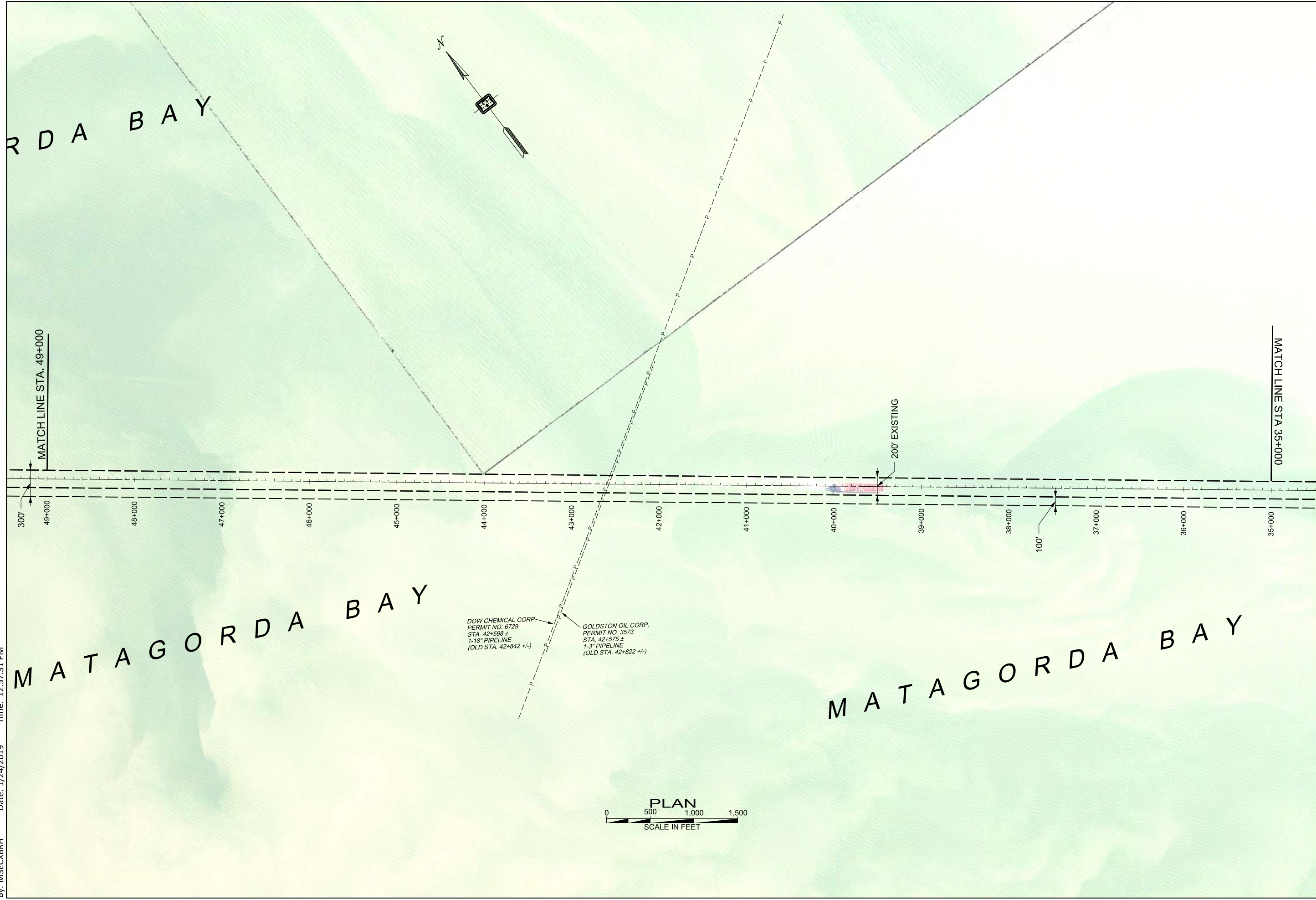

Rev.	Description	Date	By

Drawn by:	X	Date:	###	Rev.
Designed by:	X	Scale:	AS SHOWN	
Checked by:	X	Approval Recommended:		
Submitted by:	LORI K. THOMAS, P.E.	Chief, General Engineering		
	JOSEPH L. KING, R.A.	Chief, Engineering Branch		
Approved by:	ROBERT C. THOMAS, P.E.	Chief, Engineering and Construction Division		

U.S. ARMY ENGINEER DISTRICT GALVESTON
 CORPS OF ENGINEERS
 GALVESTON, TEXAS
 PREPARED UNDER THE DIRECTION OF
 LARS N. ZETTERSTROM, P.E.,
 COLONEL, U.S. ARMY, COMMANDING

CHANNEL IMPROVEMENT PROJECT
 MATAGORDA SHIP CHANNEL, TEXAS
 #####
 MATAGORDA SHIP CHANNEL
 FEASIBILITY STUDY
 PLAN-STA 49+000 TO STA 35+000

Drawing No.:
C-6
 SWG FILE NO. #####

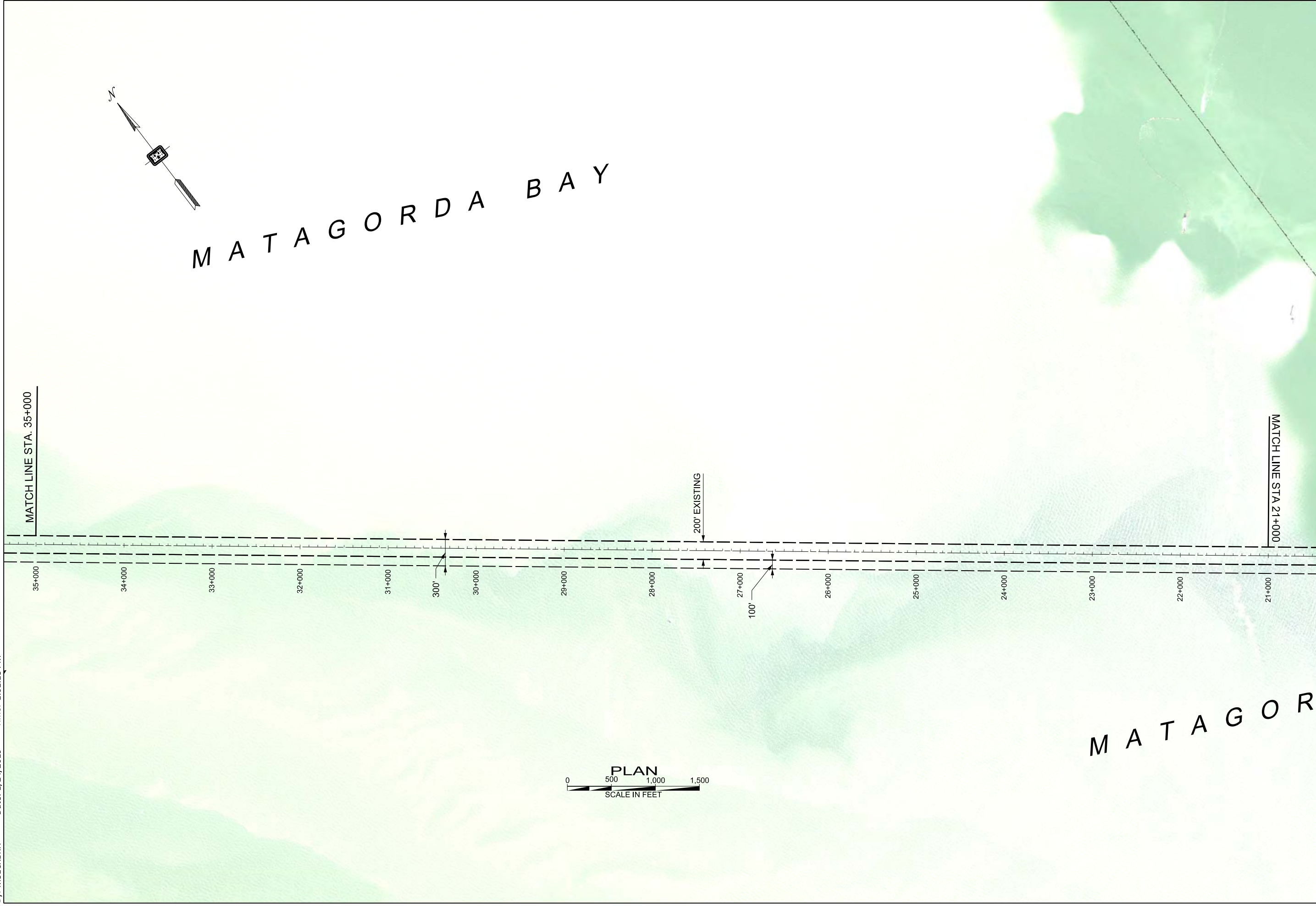

Rev.	Description	Date	By

U.S. ARMY ENGINEER DISTRICT GALVESTON CORPS OF ENGINEERS GALVESTON, TEXAS	Drawn by: X	Date: ###	Rev.
	Designed by: X	Scale: AS SHOWN	
	Submitted by: LORI K. THOMAS, P.E. Chief, General Engineering	Approval Recommended: JOSEPH L. KING, R.A. Chief, Engineering Branch	
	Approved by: ROBERT C. THOMAS, P.E. Chief, Engineering and Construction Division		

CHANNEL IMPROVEMENT PROJECT
 MATAGORDA SHIP CHANNEL, TEXAS
 #####
 MATAGORDA SHIP CHANNEL
 FEASIBILITY STUDY
 PLAN-STA 35+000 TO STA 21+000

Drawing No.:
C-7
 SWG FILE NO. ####



PLAN
 SCALE IN FEET



U.S. Army Corps
of Engineers
Galveston District

Rev.	Description	Date	By

Drawn by:	X	Date:	###
Designed by:	X	Scale:	AS SHOWN
Checked by:	X	Submitted by:	LORI K. THOMAS, P.E.
Submitted by:	LORI K. THOMAS, P.E.	Approval Recommended:	JOSEPH L. KING, R.A., Chief, General Engineering
Approved by:	ROBERT C. THOMAS, P.E.	Chief, Engineering Branch	ROBERT C. THOMAS, P.E., Chief, Engineering and Construction Division

U.S. ARMY ENGINEER DISTRICT GALVESTON
CORPS OF ENGINEERS
GALVESTON, TEXAS

PREPARED UNDER THE DIRECTION OF
LARS N. ZETTERSTROM, P.E.,
COLONEL, U.S. ARMY, COMMANDING

CHANNEL IMPROVEMENT PROJECT
MATAGORDA SHIP CHANNEL, TEXAS

MATAGORDA SHIP CHANNEL
FEASIBILITY STUDY
PLAN-STA 21+000 TO STA 8+000

Drawing No.:
C-8
SWG FILE NO. ###

File: 0-GUAD-705-238_CONTRACT-PLANS_Txs683.dgn
 Model Name: C-9-Jetty Channel
 By: M3ECKBRH Date: 1/24/2019 Time: 1:14:32 PM

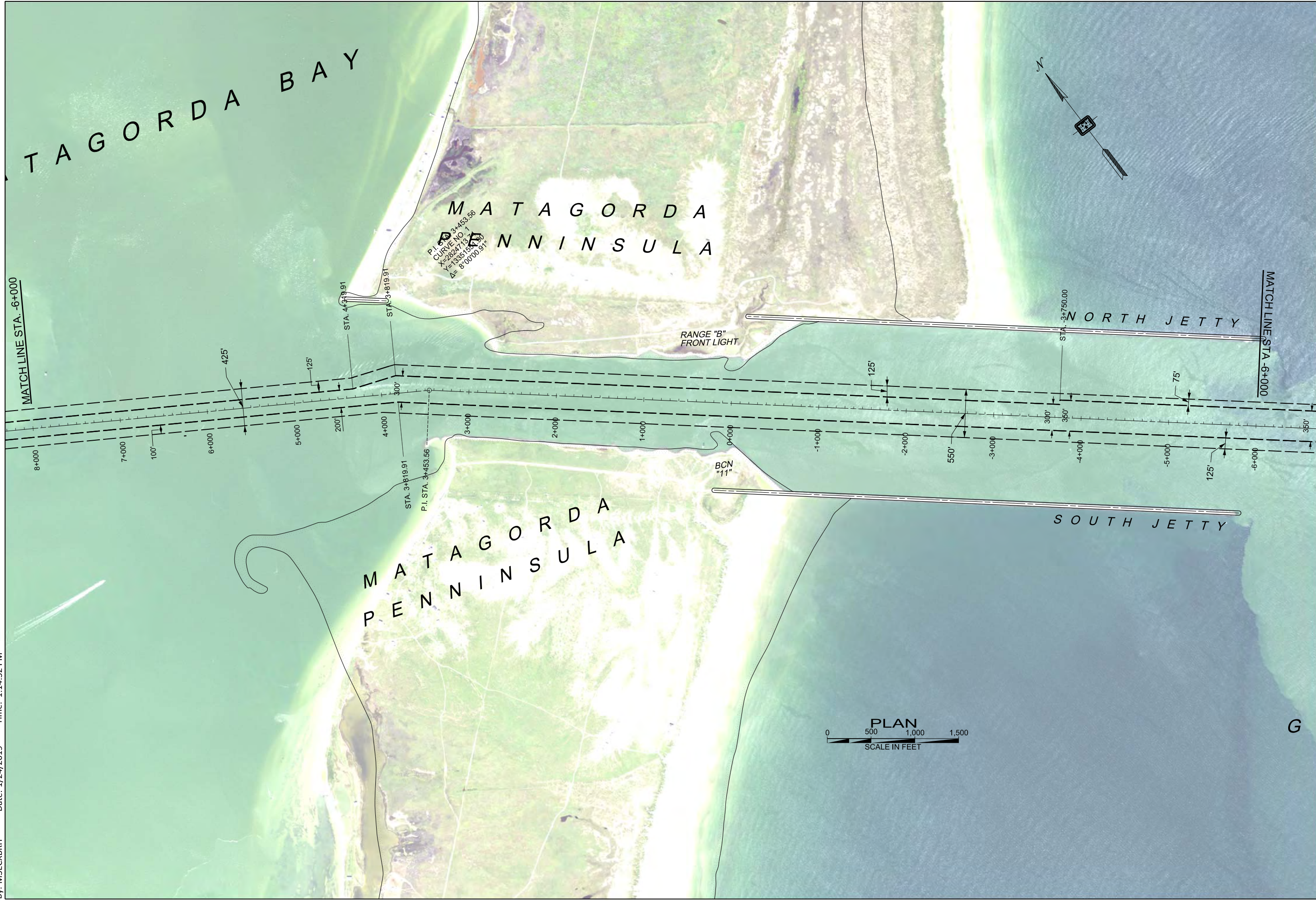

Rev.	Date	Description

Drawn by:	X	Date:	###
Designed by:	X	Scale:	AS SHOWN
Submitted by:	X	Approval Recommended:	JOSEPH L. KING, R.A., Chief, Engineering Branch
Approved by:			ROBERT C. THOMAS, P.E., Chief, Engineering and Construction Division

U.S. ARMY ENGINEER DISTRICT, GALVESTON
 CORPS OF ENGINEERS
 GALVESTON, TEXAS

PREPARED UNDER THE DIRECTION OF
 LARS N. ZETTERSTROM, P.E.,
 COLONEL, U.S. ARMY, COMMANDING

CHANNEL IMPROVEMENT PROJECT
 MATAGORDA SHIP CHANNEL, TEXAS
 ###
 MATAGORDA SHIP CHANNEL
 FEASIBILITY STUDY
 PLAN-STA 8+000 TO STA -6+000

Drawing No.:
C-9
 SWG FILE NO. ###

File: 0-GUAD-705-238_CONTRACT-PLANS_Txs683.dgn
 Model Name: C-10-Entrance Channel
 By: M3ECKBRH Date: 1/24/2019 Time: 1:43:57 PM



G U L F O F M E X I C O

G U L F O F M E X I C O



Rev.	Description	Date	By

Drawn by:	X	Date:	###
Designed by:	X	Scale:	AS SHOWN
Checked by:	X	Approval Recommended by:	JOSEPH L. KING, R.A., Chief, Engineering Branch
Submitted by:	LORI K. THOMAS, P.E. Chief, General Engineering	Approved by:	ROBERT C. THOMAS, P.E., Chief, Engineering and Construction Division

U.S. ARMY ENGINEER DISTRICT, GALVESTON
 CORPS OF ENGINEERS
 GALVESTON, TEXAS

PREPARED UNDER THE DIRECTION OF
 LARS N. ZETTERSTROM, P.E.,
 COLONEL, U.S. ARMY, COMMANDING

CHANNEL IMPROVEMENT PROJECT
 MATAGORDA SHIP CHANNEL, TEXAS
 #####
 MATAGORDA SHIP CHANNEL
 FEASIBILITY STUDY

PLAN-STA -6+000 TO STA -20+000

Drawing No.:
C-10

SWG FILE NO. #####

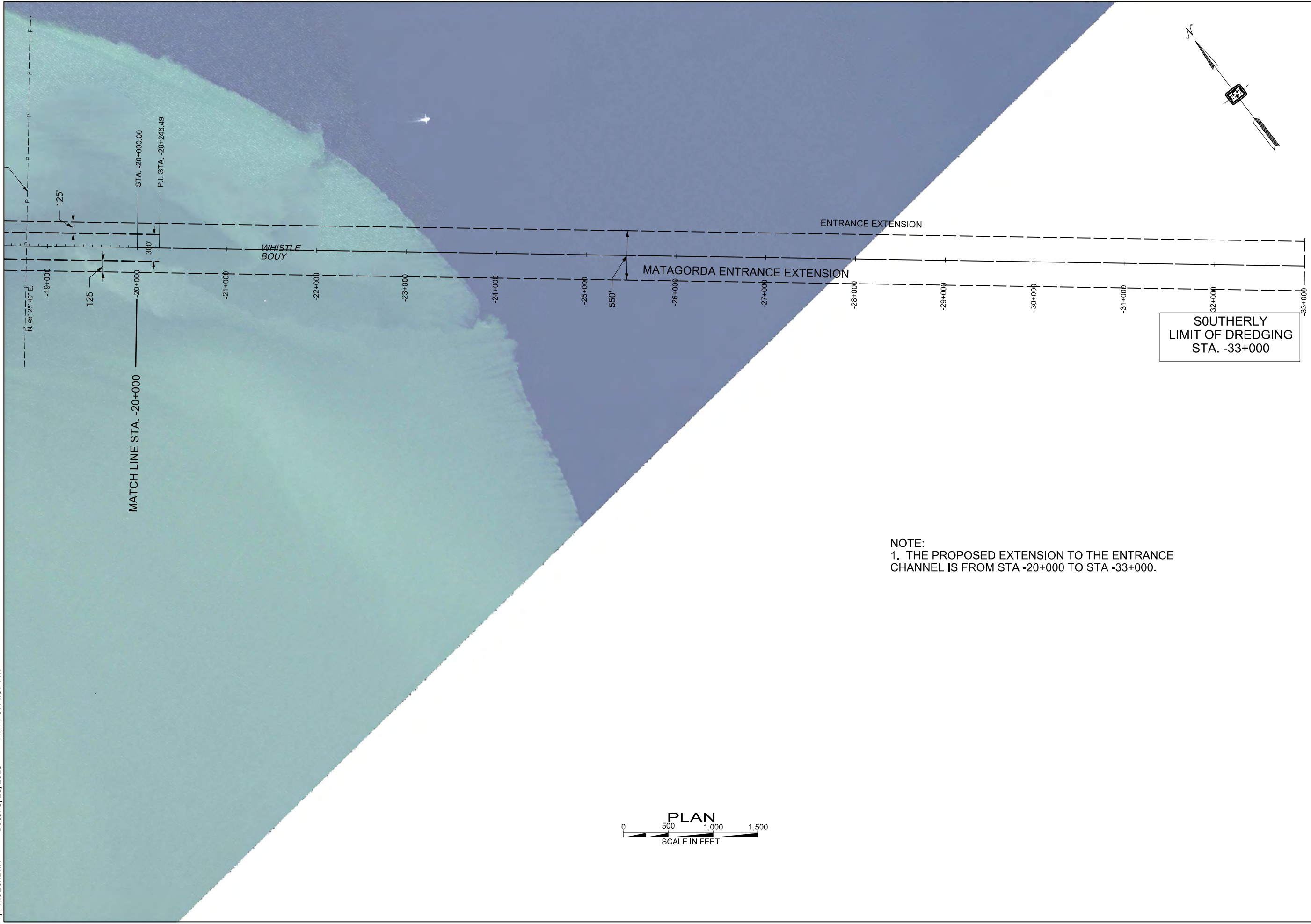

NOTE:
 1. THE PROPOSED EXTENSION TO THE ENTRANCE CHANNEL IS FROM STA -20+000 TO STA -33+000.



Rev.	Description	Date	By

Drawn by:	X	Date:		Rev.
Designed by:	X	Scale:	AS SHOWN	
Checked by:	X	Submitted by:	LORIK THOMAS, P.E.	Approval Recommended:
Submitted by:	LORIK THOMAS, P.E.	Chief, General Engineering		JOSEPH L. KING, R.A.
Approved by:	ROBERT C. THOMAS, P.E.	Chief, Engineering and Construction Division		Chief, Engineering Branch

U.S. ARMY ENGINEER DISTRICT, GALVESTON
 CORPS OF ENGINEERS
 GALVESTON, TEXAS

PREPARED UNDER THE DIRECTION OF
 LARS N. ZETTERSTROM, P.E.,
 COLONEL, U.S. ARMY, COMMANDING

CHANNEL IMPROVEMENT PROJECT
 MATAGORDA SHIP CHANNEL, TEXAS
 #####
 MATAGORDA SHIP CHANNEL
 FEASIBILITY STUDY
 PROPOSED ENTRANCE EXTENSION
 STA -20+000 TO STA -33+000

Drawing No.:
C-11
 SWG FILE NO. #####

P.I. STA. -33+000.00

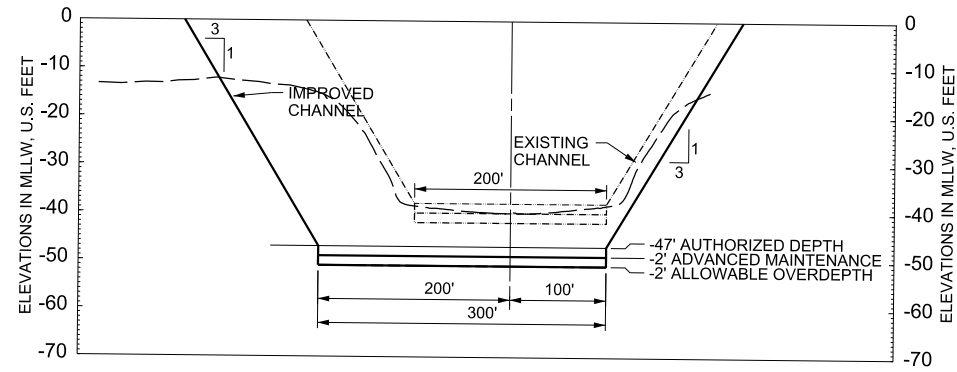

27+000
MAIN CHANNEL
TYPICAL CROSS SECTION

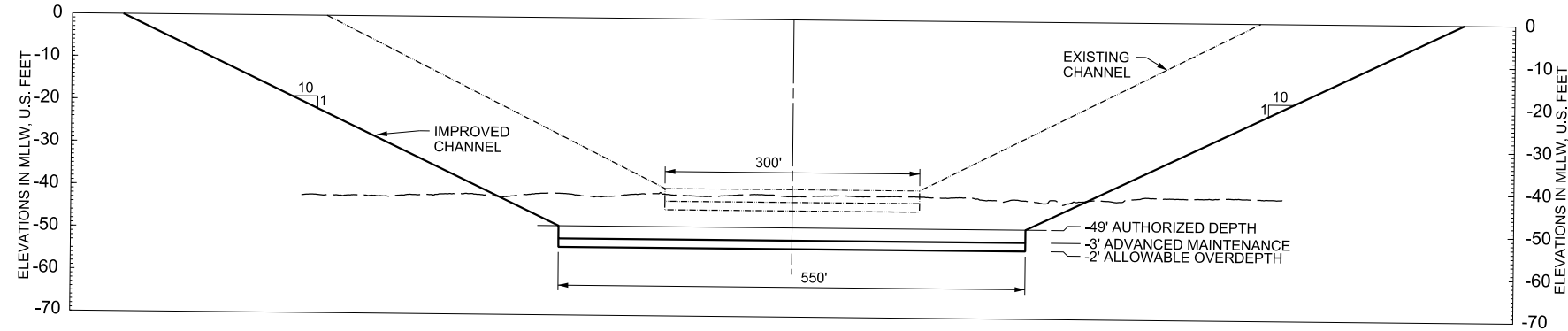

-20+000
ENTRANCE CHANNEL
TYPICAL CROSS SECTION

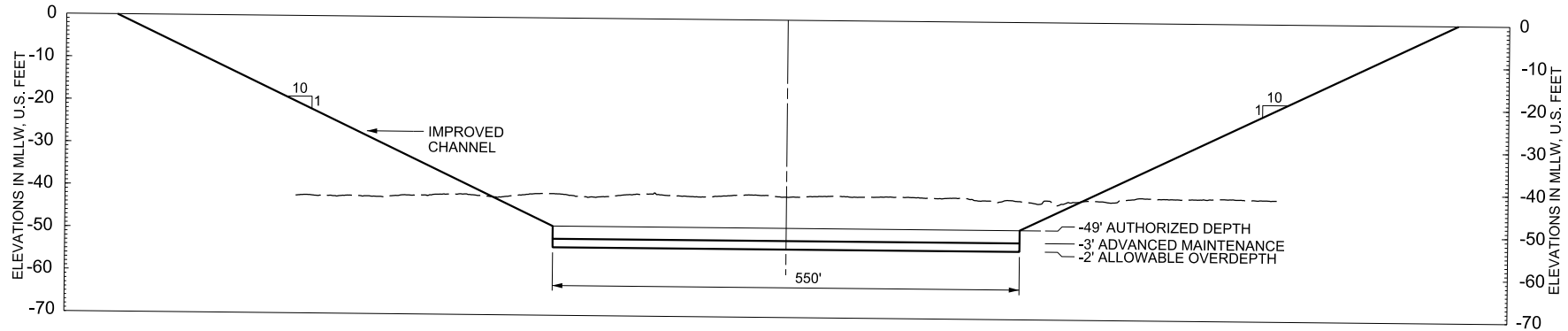

-33+000
ENTRANCE EXTENSION CHANNEL
TYPICAL CROSS SECTION



Rev.	Description	Date	By

Drawn by:	X	Date:	###	Rev.
Designed by:	X	Scale:	AS SHOWN	
Checked by:	X	Submitted by:	LORI K. THOMAS, P.E.	
Submitted by:	LORI K. THOMAS, P.E.	Approval Recommended by:	JOSEPH L. KING, R.A.	
Chief, General Engineering		Chief, Engineering Branch		
Approved by:	ROBERT C. THOMAS, P.E.	Chief, Engineering and Construction Division		

CHANNEL IMPROVEMENT PROJECT
MATAGORDA SHIP CHANNEL, TEXAS

MATAGORDA SHIP CHANNEL
FEASIBILITY STUDY
MAIN AND ENTRANCE CHANNELS
TYPICAL SECTIONS

Drawing No.:
C-12

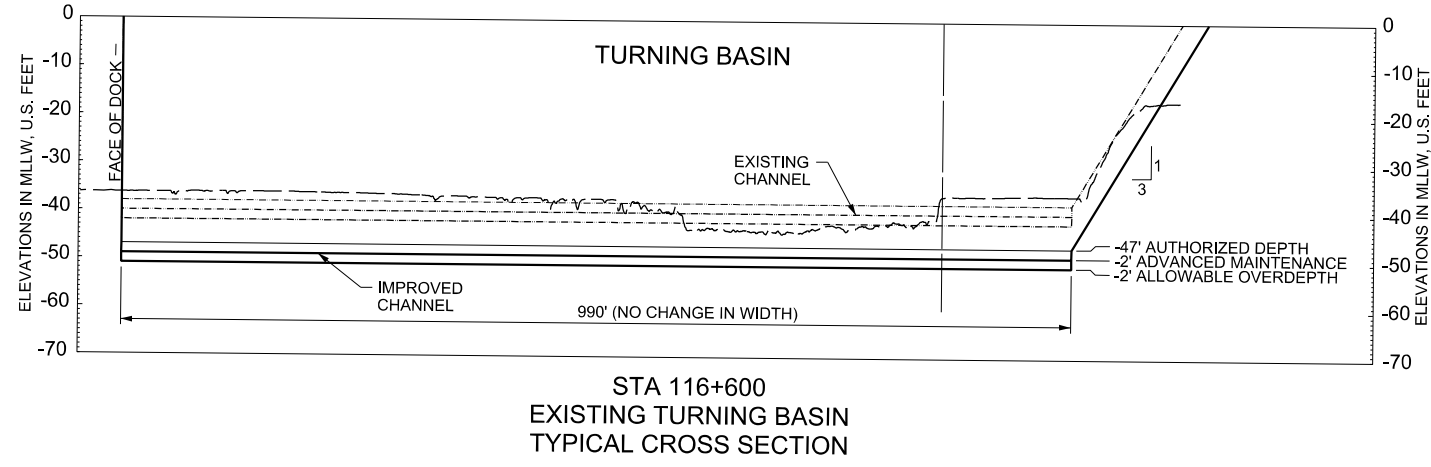
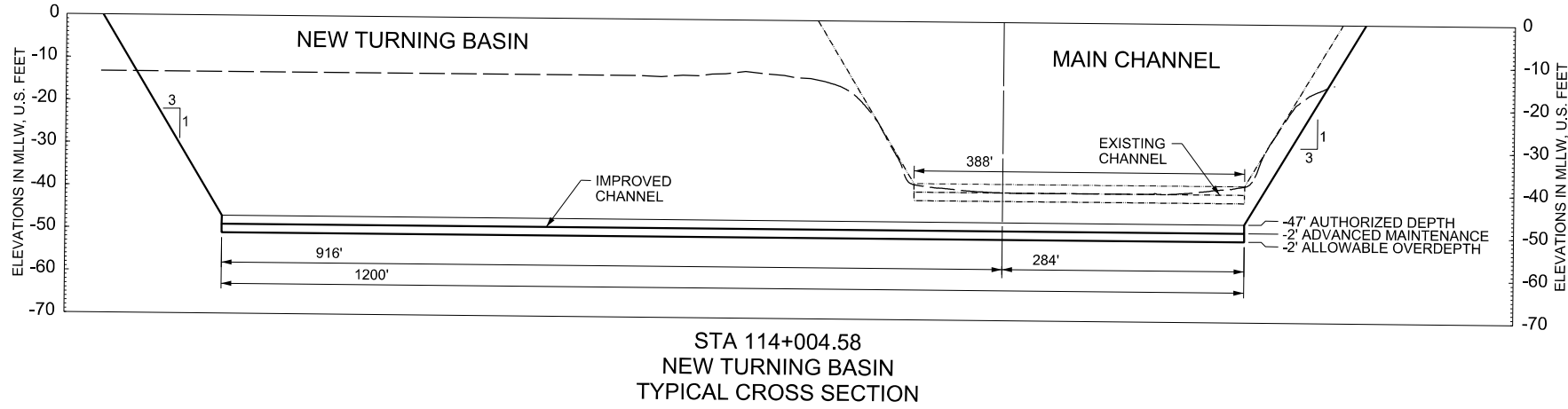

Rev.	Date	Description

Drawn by: X	Date: ###	Rev.:
Designed by: X	Scale: AS SHOWN	
Checked by: X	Approval Recommended:	
Submitted by: LORIK, THOMAS, P.E., Chief, General Engineering	JOSEPH L. KING, R.A., Chief, Engineering Branch	
Approved by: ROBERT C., THOMAS, P.E., Chief, Engineering and Construction Division		

U.S. ARMY ENGINEER DISTRICT, GALVESTON
 CORPS OF ENGINEERS
 GALVESTON, TEXAS

PREPARED UNDER THE DIRECTION OF
 LARS N. ZETTERSTROM, P.E.,
 COLONEL, U.S. ARMY, COMMANDING

CHANNEL IMPROVEMENT PROJECT
 MATAGORDA SHIP CHANNEL, TEXAS
 ##
 MATAGORDA SHIP CHANNEL
 FEASIBILITY STUDY
 EXISTING AND NEW TURNING BASINS
 TYPICAL CROSS SECTIONS

Drawing No.:
C-13
 SWG FILE NO. ##